



Vertical Powered Capstans

Designed to suit vessels up to 26m (84ft) the Muir range of capstans provide reliable and heavy duty operation for mooring, warping and anchoring for all recreational and commercial applications.

Efficient and quick they can be installed independently or as a complete system with windlasses.

Manufactured to the highest quality standard, featuring heavy chrome and gear drive assembly.

Accommodating varying deck thicknesses, they are popular for line hauling and fishing purposes. Available in 12 & 24 volt, Hydraulic & AC options.

Features

- Deck hugging snag free design
- Unit can be mounted horizontally
- Luxury chrome finish over marine grade bronze
- Capstan features heavy duty knurled finish for increased grip
- Heavy duty dual direction motor in 12 & 24V, AC & Hydraulic
- Self aligning gearbox/adaptor
- Stainless steel shaft
- Stainless steel mounting bolts
- Shaft seal
- Installation/Operation booklet



Options

- Inline drive options see page 25
- AC option (VC2500/3500/4000)
- Traditional polished bronze finish
- Heavier duty motor for lifting and fishing use
- Extra deck clearance kit for any deck thickness
- Full range of accessories including rope, snubber kits and deck switches
- Electric & hydraulic operating options & accessories



VC500

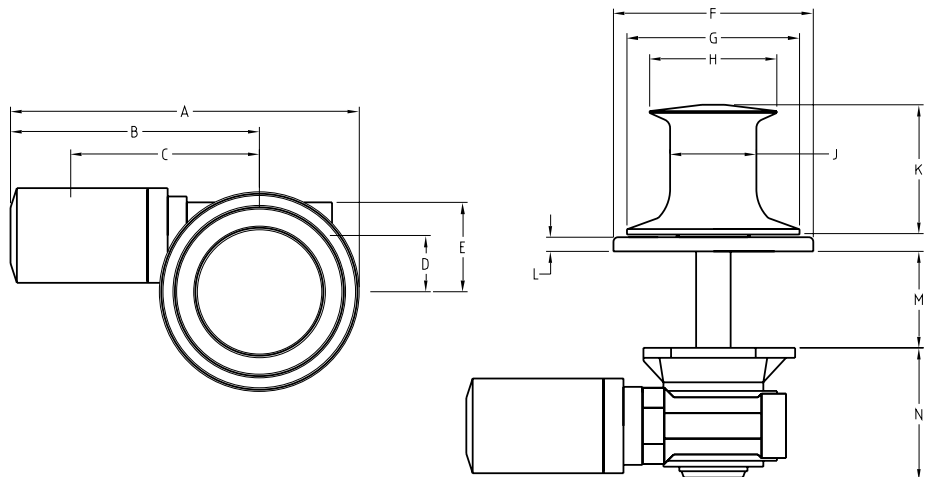



Vertical Powered Capstans

500/650/850/2500/3500/4000

Model	VC500	VC650	VC850	VC2500	VC3500	VC4000
VESSEL LENGTH	5 - 9m 16 - 29ft	8 - 11m 26 - 36ft	9 - 14m 29 - 45ft	14 - 22m 45 - 70ft	16 - 27m 51 - 86ft	20 - 36m 64 - 115ft
POWER SUPPLY (DC)	12/24V	12/24V	12/24V	12/24V	12/24V	12/24V
MOTOR (Watts)	200 or 600/600	600	1000	1200	1500	1500/2000
HYDRAULIC PRESSURE	N/A N/A	N/A N/A	N/A N/A	10MPa 1450PSI	11MPa 1600PSI	11MPa 1600PSI
HYDRAULIC FLOW	N/A N/A	N/A N/A	N/A N/A	20L/min 5.5gal/min	28L/min 7.5gal/min	28L/min 7.5gal/min
MAX LOAD	115kg/227kg 253lb/500lb	295kg 650lb	386kg 850lb	1136kg 2500lb	1590kg 3500lb	1818kg 4000lb
WORK LOAD	29kg/57kg 63lb/125lb	74kg 162lb	97kg 212lb	284kg 625lb	398kg 875lb	455kg 1000lb
AMPS WORK LOAD	40/80	80/50	80/50	120/75	150/85	120/150
MAX LINE SPEED	25m/min 80ft/min	20m/min 64ft/min	24m/min 77ft/min	15m/min 48ft/min	16m/min 53ft/min	16m/min 53ft/min
CHAIN SIZE	N/A N/A	N/A N/A	N/A N/A	N/A N/A	N/A N/A	N/A N/A
ROPE SIZE	10 - 12mm 3/8 - 1/2"	10 - 12mm 3/8 - 1/2"	10 - 14mm 3/8 - 9/16"	12 - 19mm 1/2 - 3/4"	14 - 25mm 9/16 - 1"	14 - 25mm 9/16 - 1"
NET WEIGHT	DC 6kg/7kg DC 13lb/15lb	DC 12kg DC 26lb	DC 16kg DC 35lb	DC 25kg HYD 23kg DC 55lb HYD 51lb	DC 27kg HYD 19kg DC 59lb HYD 42lb	DC 57kg HYD 51kg DC 126lb HYD 112lb

VERTICAL POWERED CAPSTAN DIMENSIONS

Model	VC500	VC650	VC850	VC2500	VC3500	VC4000
A	262mm 10.31"	277mm 10.90"	315mm 12.40"	425mm 16.73"	438mm 17.24"	527mm 20.75"
B	198mm 7.79"	220mm 8.66"	245mm 9.65"	328mm 12.91"	328mm 12.91"	403mm 15.87"
C	N/A N/A	N/A N/A	N/A N/A	261mm 10.28"	261mm 10.28"	307mm 12.09"
D	45mm 1.77"	45mm 1.77"	49mm 1.93"	62mm 2.44"	62mm 2.44"	87mm 3.43"
E	71mm 2.79"	71mm 2.79"	80mm 3.15"	97mm 3.82"	97mm 3.82"	126mm 4.96"
F	127mm 5.0"	114mm 4.49"	139mm 5.47"	190mm 7.48"	220mm 8.66"	250mm 9.84"
G	100mm 3.94"	114mm 4.40"	133mm 5.24"	190mm 7.48"	190mm 7.48"	229mm 9.02"
H	82mm 3.23"	104mm 4.09"	108mm 4.25"	140mm 5.51"	140mm 5.51"	198mm 7.80"
J	63mm 2.48"	75mm 2.95"	85mm 3.35"	95mm 3.74"	95mm 3.74"	141mm 5.55"
K	75mm 2.95"	95mm 3.74"	118mm 4.65"	142mm 5.59"	142mm 5.59"	171mm 6.73"
L	7mm 0.27"	7mm 0.27"	12mm 0.47"	10mm 0.39"	10mm 0.39"	17mm 0.67"
M	54mm 2.12"	51mm 2.00"	51mm 2.00"	112mm 4.40"	112mm 4.40"	121mm 4.76"
N	98mm 3.86"	100mm 3.93"	144mm 5.67"	146mm 5.75"	146mm 5.75"	181mm 7.13"