

Special cleats

A wide range of specialised glass filled nylon cleats designed for a variety of uses onboard.

Tubular cleats

Available in 2 sizes, these handy cleats have many uses where light loads are expected.

The Barton 'Line Tamer'

A line storage device designed to keep cockpits free from unused lines and halyards. A smooth profile ensures no snagging as crew members brush past. Sold in pairs in grey or white.

Full fitting instructions are included. Suitable for rope coils of up to 20cm diameter.

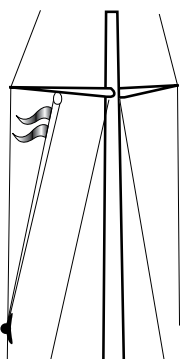

Shroud cleats

Two handy cleats that simply clamp onto shroud wire (max 8mm Ø) without causing damage.

52110 is a plain cleat for flag halyards etc.

52111 features a wide eye opening for stowage of halyard shackles.



6	7	8	9	10	11
52140	52141	52142	52143	52144	52145



12 60142

Stanchion bullseye

Designed to fit stanchions or pushpit/pullpit tubes, suitable for line up to 12mm.

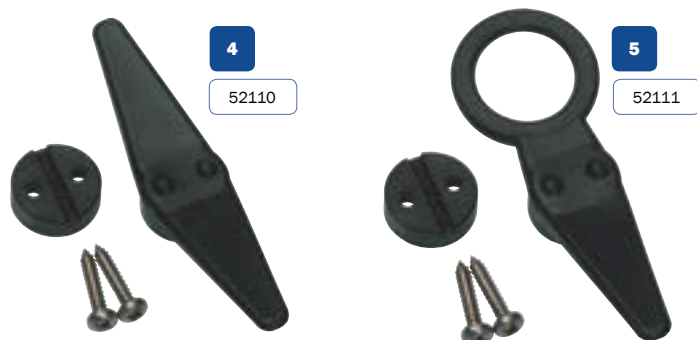

No.		Part number	Cleat material	Length (mm)	Weight (g)	Fastenings Ø (mm)
Line Tamer						
1	Line Tamer grey (pair)	52000	Nylon	73	12	-
2	Line Tamer white (pair)	52001	Nylon	73	12	-
Stanchion cleat						
3	Stanchion cleat	52100	Nylon	111	90	-
Shroud cleat						
4	Shroud cleat	52110	Nylon	100	26	-
5	Shroud cleat with eye	52111	Nylon	100	26	-
Open nylon cleat						
6	Open cleat	52140	Nylon	75	6	3
7	Open cleat	52141	Nylon	100	12	4
8	Open cleat	52142	Nylon	130	26	4
9	Open cleat	52143	Nylon	170	49	5
10	Open cleat	52144	Nylon	210	84	6
11	Open cleat	52145	Nylon	245	157	8
Stanchion bullseye						
12	Stanchion bullseye	60142	Nylon	bullseye int. Ø 17mm		

No.		Part number	Length (mm)	Fastenings Ø (mm)	Weight (g)	Bore (int Ø) (mm)
Tubular cleats						
13	Tube cleat	52120	55	4	4	8
14	Tube cleat	52121	80	6	13	13



3 52100

Stanchion cleat

Designed to fit stanchions or pushpit/pullpit tubes - fits in seconds and features soft nylon jaws that will not damage the tube.

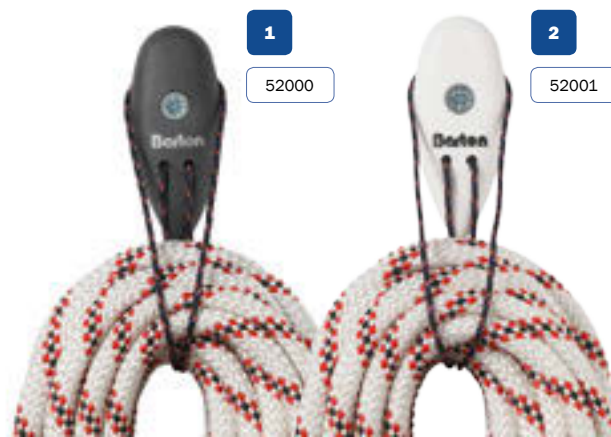



The ClamSeal™

REPAIRS INFLATABLES – FAST

DAME award category winner.

Winner of a National Marine Manufacturer's Association Product Innovation Award.

The award-winning, patented ClamSeal™ - repairs inflatables fast - even when wet

The ClamSeal™ can instantly repair splits and tears up to 90mm (3½") in length without the use of any hand tools, or adhesive.

ClamSeal™ is a patented glue-less repair system that instantly repairs small tears or splits in inflatables above or below the waterline - regardless of the fact that the material may be wet.

The system works by using two half 'shells' that screw together tightly, using the inflatable material itself as a water and air-tight seal. It is quick and easy to fit and effects an immediate repair which can keep you afloat until a more permanent repair can be made.

- Quick and easy to fit
- Requires no adhesive or tape
- Can be used above or below the waterline
- Can be used on wet materials
- Provides an instant repair
- Re-useable again and again.

The ClamSeal™ can be carried as part of your emergency equipment onboard. It can be used at sea, on shore; even underwater as no adhesive or tape is involved. The clever mechanics of the ClamSeal™ design mean this simple product can keep you safely afloat.

The ClamSeal™ has now become a permanent part of the safety kit on many RIBs around the world and is continuing to amaze those who have used them - an effective, low cost solution to an otherwise complicated problem.

ClamSeal™ is suitable for use on:

- RIBs
- Dinghies
- Liferrafts
- Buoyancy bags
- Virtually any inflatable product.



60001

Pat pending GB0329522.7

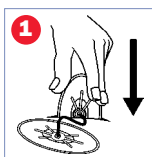

1
Open the ClamSeal™ and insert the base plate into the split.



2
Pull the plates of the ClamSeal™ together, across the split, using the lanyard

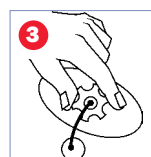

3
With the 2 plates pulled together, simply hand-tighten the nut for a Clam-tight seal!

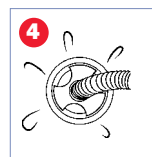

4
Reinflate and you're safe to continue on your way!

	Part number
ClamSeal™	
Barton ClamSeal™	60001

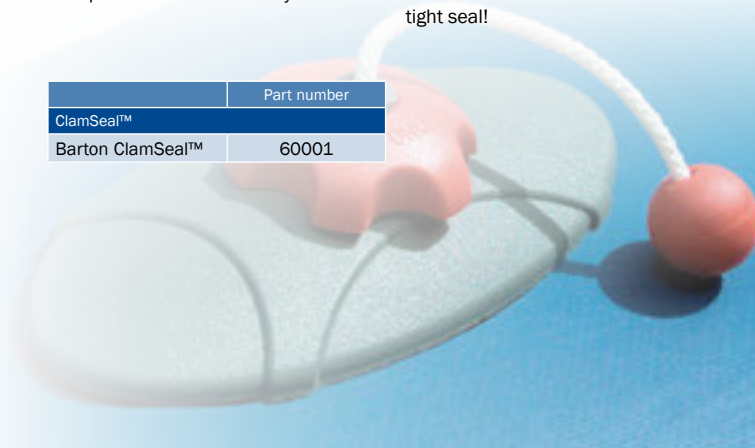

20mm 'T' section track, sliders, genoa cars

Plain bearing genoa cars and sliders

A lightweight and compact range of plain bearing extruded aluminium sliders, running on 20mm (3/4") 'T' track and manufactured from high quality marine grade aluminium with our unique 'Spectro' grey anodised finish for added protection.

This useful range will find a wide variety of applications on larger dinghies, dayboats and light cruiser/racers.

See page 77 for our suggested boat size table designed to help you clarify the correct size of sliders for your application.

1



22100

2



22200

3



22220

4



22210

5



22221

6



22300

7



22301

9



22310

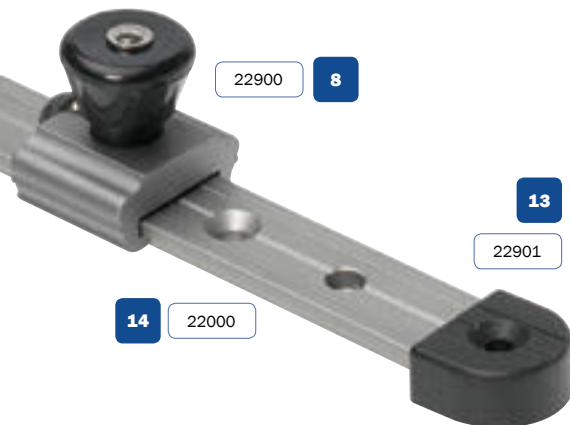

20mm 'T' section track

For use with all sliders featured on this page. Drilled for fastenings and plunger stops. 'Spectro' grey anodised and supplied in metric lengths.

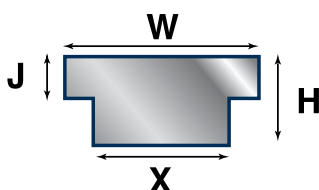

Specifications and dimensions

	Width W	20mm
	Width X	11mm
	Height H	8mm
	Height J	2.5mm
	Fastenings Ø	5mm
	Fastening centres	100mm
	Plunger hole centres	50mm
	Weight	270g per m

10



22311

No.		Part number
20mm 'T' section track		
14	Per metre	22000
	0.6 metre	22010
	1.2 metre	22020
	1.8 metre	22030
	2.4 metre	22040
	3.0 metre	22050
	5.0 metre	22060
	Track end cap (pair)	22901

Genoa car with plunger stop

Features a precision turned Ertalyte sheave, through-bolted for extra strength. The positive action plunger mechanism has an easy-grip knob (see page 6 for setup options).

Towable genoa cars

With tow eye or sheave in place of plunger, allowing a control line to be lead aft so that genoa car adjustments can be made from the cockpit. Use in conjunction with end fittings shown.

Genoa and mainsheet slides

A strong unit which will accept most Barton blocks - with a stainless steel attachment loop, through-bolted for strength.

Bullseye slide

With a swivelling bullseye that will always accommodate the correct angle of sheeting. Accepts lines up to 14mm diameter. A stainless steel insert is provided to prevent wear.

Fairlead slide

Features a plain moulded plastic fairlead fitted to an adjustable slide. Accepts lines up to 12mm diameter; not suitable for high loads.

Stand up block

Has a stainless eye fitted to a stainless loop, through-bolted for strength. The moulded plastic spring/gaiter prevents the block tumbling or ropes snagging. Supplied with a series 2 block accepting lines up to 8mm diameter.

Plunger stops

For use with mainsheet or genoa track sliders. Sold singly.

11



42102

12



22312

No.		Part number	Length (mm)	Width (mm)	Height (mm)	Sheave Ø (mm)	Max rope Ø (mm)	Break load (kg)	SWL (kg)	Weight (g)
Genoa cars and towable genoa cars										
1	Genoa car	22100	60	34	65	30	10	1160	580	119
2	Towable genoa car	22200	110	34	65	30	10	1160	580	127
3	Towable genoa car 2:1 purchase	22220	138	34	65	30	10	1160	580	160
Towable car end fittings										
4	Track end	22210	80	32	36	30	8	-	-	97
5	Track end + becket	22221	80	32	47	30	8	-	-	99
Mainsheet/genoa slides and stops										
6	Mainsheet slide	22300	60	32	35	-	-	1200	600	55
7	Genoa slide	22301	60	32	35	-	-	1200	600	68
8	Plunger stop	22900	30	32	30	-	-	-	-	30
Bullseye and fairlead slides										
9	Bullseye slide	22310	80	32	60	-	14	400	200	150
10	Fairlead slide	22311	90	32	42	-	12	400	200	102
11	Fairlead + cam (handed pair)	42102	90	-	-	-	12	-	-	732
Stand up block										
12	Stand up block	22312	75	32	115	35	8	740	370	195
Track end cap (pair)										
13	Track end caps (supplied in pairs)	22901	20	-	-	-	-	-	-	55

25mm 'T' section track, sliders, genoa cars

Plain bearing genoa cars, sliders and spinnaker pole slides

A popular range of genoa cars and sliders designed to run on 25mm (1") 'T' track. All are manufactured from high quality marine grade aluminium with our unique 'Spectro' grey anodised finish for added protection.

All cars and sliders featured on these pages have moulded nylon inserts to ensure free, smooth running under load and prevent damage to finish or potential corrosion.

- 'Spectro' grey anodised finish
- Stainless plunger stops with positive action
- Moulded nylon slide inserts ensure free running
- Large, easy-grip plunger knobs.

Cars and sliders are compatible with all makes of 'T' track.

See page 77 for our suggested boat size table designed to help you clarify the correct size of sliders for your application.

10

25900

14

25000

13

25901

No.		Part number
25mm 'T' section track		
14	Per metre	25000
	0.6 metre	25010
	1.2 metre	25020
	1.8 metre	25030
	2.4 metre	25040
	3.0 metre	25050
	5.0 metre	25060
13	Track end cap (pair)	25901

1



25100

2



25200

3



25220

4



25210

5



25221

6



25300

7



25301

11



25303

12



25311

no.	Description:	Part number	Length (mm)	Width (mm)	Height (mm)	Sheave Ø (mm)	Max rope Ø (mm)	Break load (kg)	SWL (kg)	Weight (g)
Genoa cars and towable genoa cars										
1	Genoa car	25100	80	42	87	40	2 x 12	2280	1140	247
2	Towable genoa car	25200	127	42	87	40	2 x 12	2280	1140	258
3	Towable genoa car 2:1 purchase	25220	170	42	87	40	2 x 12	2280	1140	297
Towable car end fittings										
4	Track end (no insert required)	25210	88	37	35	35	8	-	-	116
5	Track end + becket	25221	88	37	50	35	8	-	-	121
Mainsheet/genoa slides and stops										
6	Mainsheet slide	25300	80	42	42	-	-	2860	1430	111
7	Genoa slide	25301	80	42	40	-	-	2860	1430	123
10	Plunger stop	25900	30	33	34	-	-	-	-	36
Bullseye slide										
11	Bullseye slide	25303	80	42	60	-	14	-	-	184
Stand up blocks										
	Stand up block - size 3	25310	80	42	120	45	10	980	490	223
12	Stand up block - size 4	25311	80	42	142	57	12	1580	790	312
Track end cap (pair)										
13	Track end caps (supplied in pairs)	25901	23	-	-	-	-	-	-	11

25mm 'T' section track

For use with all sliders featured on this page. Drilled for fastenings and plunger stops. 'Spectro' grey anodised and supplied in metric lengths.

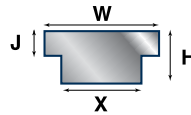

15



51253

16



51254

Sliding cleats

A cost-effective solution to fitting a mid-ship spring cleat where access under the side deck is limited - simply remove a genoa track end stop, slide on the cleat and lock it in the desired position.

When not in use, slide the cleat to one end of the track, or leave off one track end permanently to enable easy removal of cleat.

Alternatively, fit a short length of track in the desired position so that cleats can be fitted when required and removed when not in use - reducing deck clutter and rope snags.

25mm cleats have an extruded aluminium base, nylon moulded cleat and screw type lock.

No.	Description:	Part number	Cleat material	Length (mm)	'T' track width (mm)	Weight (g)
Sliding cleat						
15	165mm sliding cleat	51253	Nylon	165	25	134
16	200mm sliding cleat	51254	Nylon	200	25	178

8



25302

9



25304

No.	Description:	Part number	Length (mm)	Width (mm)	Height (mm)	Eye internal Ø (mm)	Weight (g)
Spinnaker pole slides							
8	Spinnaker pole slide	25302	80	42	74	35	237
9	Towable spinnaker pole slide	25304	80	42	74	35	253

17



82995

18



82996

No.	Description:	Part number	Sheave Ø (mm)	Sheave width (mm)	Rope Ø (mm)	Break load (kg)	SWL (kg)	Length (mm)	Fastenings (mm)	Weight (g)
Foot blocks										
17	Foot block - 50mm	82995	50	15	12	1000	500	79	3 x M6	114
18	Foot block - 65mm	82996	65	18	16	1600	800	100	2 x M6 / 1 x M8	211
	Foot block - 85mm	82997	85	21	18	3000	1500	132	2 x M8 / 1 x M10	427

Important note - foot blocks:

Fastenings of the minimum diameter suggested should be used to gain full load capacity. Ensure that suitable mounting pads are provided under deck. Stacking blocks to achieve doubles will severely reduce working loads quoted.

Specifications and dimensions

	Width W	25mm
	Width X	14mm
	Height H	10mm
	Height J	4mm
	Fastenings Ø	5mm
	Fastening centres	100mm
	Plunger hole centres	50mm
	Weight	441g per m

Genoa car with plunger stops

Features precision turned Ertalyte sheaves running on a large diameter centre bearing, for friction-free performance under load. Sheaves are designed with extra width to accept two sheets. The sheave axle is through-bolted and riveted for extra strength (see page 6 for setup options).

Towable genoa cars

With tow eye or sheave in place of plunger, allowing a control line to be lead aft so that genoa car adjustments can be made from the cockpit. Use in conjunction with end fittings shown.

Genoa and mainsheet slides

Have a heavy-duty stainless steel attachment loop, through-bolted and riveted for extra strength. These units will accept most Barton blocks featured on pages 8-25.

Bullseye slide

Features a swivelling bullseye that will always accommodate the correct angle of sheeting. A stainless steel insert is provided to prevent wear. Accepts lines up to 14mm diameter.

Spinnaker pole slide

Have a heavy-duty stainless steel ring welded to an attachment plate which is through-bolted to the slide. Generous ring opening to accept most pole ends.

Towable spinnaker pole slide

Have eyes fitted to both ends of the slide for the attachment of control lines. Use with 25210 end fittings (see page 7 for setup options).

Stand up blocks

Have a stainless steel eye fitted to a stainless steel loop, through-bolted for strength. The moulded plastic spring/gaiter prevents the block tumbling or ropes snagging. Two sizes are available - for 10mm and 12mm lines.

Foot blocks

Designed for use with the genoa cars shown in this range, these strong foot blocks have a three-bolt fixing and can be stacked to achieve doubles (see note below). 'Spectro' grey finish. Precision turned Ertalyte sheaves run on large diameter centre bearing to give low friction performance under high loads.

See page 29 for further details and our foot block with cam range.

32mm 'T' section track, sliders, genoa cars

Plain bearing genoa cars, sliders and spinnaker pole slides, plus stand up blocks

A popular range of genoa cars and sliders designed to run on 32mm (1 1/4") 'T' track. All are manufactured from high quality marine grade aluminium with our unique 'Spectro' grey anodised finish for added protection.

All cars and sliders featured on these pages have moulded nylon inserts to ensure free, smooth running under load and prevent damage to finish or potential corrosion.

All genoa cars in this range are available in a heavy-duty version for larger craft or for larger load applications.

- 'Spectro' grey anodised finish.
- Stainless steel plunger stops with positive action.
- Moulded nylon slide inserts ensure free running.
- Large, easy-grip plunger knobs.
- Heavy-duty genoa car options.

Cars and sliders are compatible with all makes of 'T' track. Modified slider inserts available for obscure sizes. Please contact Barton Marine for further information.

See page 77 for our suggested boat size table designed to help you clarify the correct size of sliders for your application.

32900

11

14

32000

13

32901

No.		Part number
32mm 'T' section track		
14	Per metre	32000
	0.6 metre	32010
	1.2 metre	32020
	1.8 metre	32030
	2.4 metre	32040
	3.0 metre	32050
	5.0 metre	32060
13	Track end cap (pair)	32901

1

32100

2

32101

3

32200

4

32201

5

32210

6

32211

7

32220

8

32221

9

32300

	Description:	Part number	Length (mm)	Width (mm)	Height (mm)	Sheave Ø (mm)	Max rope Ø (mm)	Break load (kg)	SWL (kg)	Weight (g)
Genoa cars and towable genoa cars										
1	Genoa car	32100	109	52	102	50	2 x 16	3280	1640	469
2	Genoa car - heavy-duty	32101	127	55	117	60	2 x 16	5970	2985	728
3	Towable genoa car	32200	170	52	102	50	2 x 16	3280	1640	503
4	Towable genoa car - heavy-duty	32201	190	55	117	60	2 x 16	5970	2985	749
5	Towable genoa car 2:1 purchase	32210	220	52	102	50	2 x 16	3280	1640	561
6	Towable genoa car 2:1 purchase - heavy-duty	32211	235	55	117	60	2 x 16	5970	2985	820
Towable car end fittings										
7	Track end (no insert required)	32220	109	47	44	45	10	-	-	230
8	Track end + becket	32221	109	47	58	45	10	-	-	236
Mainsheet/genoa slides and stops										
9	Mainsheet slide	32300	109	52	50	-	-	2980	1490	231
10	Genoa slide	32301	109	52	50	-	-	2980	1490	254
11	Plunger stop	32900	35	42	40	-	-	-	-	70
Stand up blocks										
12	Stand up block - size 5	32310	109	52	150	54	12	1800	900	450
	Stand up block - size 6	32311	109	52	165	60	12	2300	1150	489
	Stand up block - size 7	32312	109	52	170	72	14	2800	1400	565
Track end cap (pair)										
13	Track end caps (supplied in pairs)	32901	29	-	-	-	-	-	-	19

32mm 'T' section track

For use with all sliders featured on this page. Drilled for fastenings and plunger stops. 'Spectro' grey anodised and supplied in metric lengths.

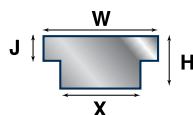

Sliding cleats

A cost-effective solution to fitting a mid-ship spring cleat where access under the side deck is limited - simply remove a genoa track end stop, slide on the cleat and lock it in the desired position.

When not in use, slide the cleat to one end of the track, or leave off one track end permanently to enable easy removal of cleat.

Alternatively, fit a short length of track in the desired position so that cleats can be fitted when required and removed when not in use - reducing deck clutter and rope snags.

32mm cleats have an extruded aluminium base, cast aluminium cleat and plunger type lock.

No.	Description:	Part number	Cleat material	Length (mm)	'T' track width (mm)	Weight (g)
Sliding cleat						
17	175mm sliding cleat	51322	Alu	175	32	328
18	205mm sliding cleat	51323	Alu	205	32	402



No.	Description:	Part number	Length (mm)	Width (mm)	Height (mm)	Eye internal Ø (mm)	Weight (g)
Spinnaker pole slides							
15	Spinnaker pole slide	32302	109	52	80	40	357
16	Towable spinnaker pole slide	32304	109	52	80	40	359



No.	Description:	Part number	Sheave Ø (mm)	Sheave width (mm)	Rope Ø (mm)	Break load (kg)	SWL (kg)	Length (mm)	Fastenings (mm)	Weight (g)
Foot blocks										
19	Foot block - 50mm	82995	50	15	12	1000	500	79	3 x M6	114
	Foot block - 65mm	82996	65	18	16	1600	800	100	2 x M6 / 1 x M8	211
	Foot block - 85mm	82997	85	21	18	3000	1500	132	2 x M8 / 1 x M10	427

Important note - foot blocks:

Fastenings of the minimum diameter suggested should be used to gain full load capacity. Ensure that suitable mounting pads are provided under deck. Stacking blocks to achieve doubles will severely reduce working loads quoted.

Specifications and dimensions

	Width W	32mm
	Width X	20mm
	Height H	15mm
	Height J	5mm
	Fastenings Ø	6mm
	Fastening centres	100mm
	Plunger hole centres	50mm
	Weight	756g per m

Genoa cars with plunger stops

Feature precision turned Ertalyte sheaves running on a large diameter centre bearing, for friction-free performance under load. Sheaves are designed with extra width to accept two sheets. The sheave axle is through-bolted and riveted for extra strength (see page 6 for setup options).

Towable genoa cars

With tow eye or sheave in place of plunger, allowing a control line to be lead aft so that genoa car adjustments can be made from the cockpit. Use in conjunction with end fittings shown.

Genoa and mainsheet slides

With a heavy-duty stainless steel attachment loop, through-bolted and riveted for extra strength. These units will accept most Barton blocks featured on pages 8-25.

Spinnaker pole slide

Has a heavy duty stainless steel ring welded to an attachment plate which is through-bolted to the slide. Generous ring opening to accept most pole ends.

Towable spinnaker pole slide

Have eyes fitted to both ends of the slide for the attachment of control lines. Use with 32220 end fittings (see page 7 for setup options).

Stand up blocks

Have a stainless steel eye fitted to a stainless steel loop, through-bolted for strength. The moulded plastic spring/gaiter prevents the block tumbling or ropes snagging. Three sizes are available - for lines up to 14mm.

Foot blocks

Designed for use with the genoa cars shown in this range, these strong foot blocks have a three-bolt fixing and can be stacked to achieve doubles (see note below). 'Spectro' grey finish. Precision turned Ertalyte sheaves run on large diameter centre bearing to give low friction performance under high loads.

See page 29 for further details and our foot block with cam range.

Towable 'T' track genoa cars

An established favourite with sailors around the globe, Barton 'T' track genoa cars are compatible with all types of 'T' Track. The advantage of a line adjust system is that the crew do not have to leave the safety of the cockpit to obtain perfect trim when reefing the headsail.

We have developed our current design and have incorporated control line sheaves within the body of the sliders and end fittings. The result is a more compact unit with less likelihood of sheet fouling, plus they look great too!

The towable 'T' track genoa car system is available in three sizes for yachts from 6m – 12m (18' – 40'), this includes 20mm 'T' track, 25mm 'T' track and 32mm 'T' track (both standard and heavy duty options).

No.		Part number
Genoa cars with towable end fittings		
1	20mm 'T' track towable genoa car	22220
2	20mm 'T' track end fitting (single)	22221
3	25mm 'T' track towable genoa car	25220
4	25mm 'T' track end fitting (single)	25221
5	32mm 'T' track towable genoa car	32210
6	32mm 'T' track towable genoa car (heavy duty)	32211
7	32mm 'T' track end fitting (single)	32221



Working Jib Position

Furled to second marker on foot of Genoa.
Genoa car moved forward from position 2 to position 3 for optimum windward sailing performance.

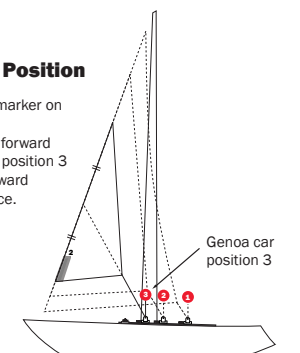

No.2 Genoa Position

Furled to first marker on foot of Genoa.
Genoa car moved forward from position 1 to position 2 for optimum windward sailing performance.

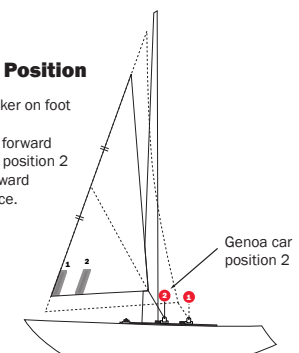

Full Sail

Genoa car in optimum position for windward sailing performance.
Rule of thumb - Sheet lead angle bisects luff length of Genoa.

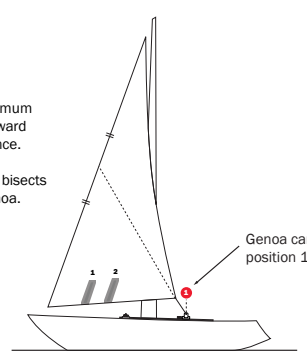

Please see our suggested boat size table on page 77, to assist you in making the correct choice when determining the correct size of fitting for our application.



Deck organisers

Available in two sheave sizes and in 2, 3, 4, 5 and 6-sheave models

Designed for use when leading control lines and halyards across the coach roof and back to the cockpit.

This range features aluminium construction with 'Spectro' grey anodised finish. Sheaves are from moulded Acetal with hollow stainless rivets to allow easy and tidy fitting (see page 7 for setup options).

Please see our suggested boat size table on page 77, to assist you in making the correct choice to determine the right size of fitting for your application.

Specifications



Sheave Ø
Sheave width

Size 1

32mm
17mm

Size 2

44mm
18mm



Fastenings

6mm

8mm



Max line Ø

12mm

14mm



Hole centres

43mm

58mm

1

81582

2

81583

3

81584

4

81585

5

81586

No.	Description:	Part number	Length (mm)	Width (mm)	Height (mm)	Weight (g)
Size 1 deck organisers						
1	2-sheave	81582	115	28	25	108
2	3-sheave	81583	157	28	25	155
3	4-sheave	81584	200	28	25	200
4	5-sheave	81585	244	28	25	244
5	6-sheave	81586	287	28	25	295
Size 2 deck organisers						
	2-sheave	81682	148	38	28	205
	3-sheave	81683	205	38	28	290
	4-sheave	81684	262	38	28	378
	5-sheave	81685	318	38	28	465
	6-sheave	81686	376	38	28	555

Rope clutches and mast base organiser

Rope clutches

Manufactured from high grade plastics and aluminium with ‘Spectro’ grey anodised finish.

Lines can be drawn through the clutch in the locked position as the line moves freely in the direction of pull and is restricted from returning by a spring-loaded cam mechanism.

This compact range is suitable for securing halyards and control lines on yachts up to approx 30ft - or for lighter duties on large craft (see page 7 for setup options).

Specifications



Max holding capacity



Max rope capacity



Fastenings



Hole centres

350kg

10mm

6mm

88mm

Locking levers come in grey, red and white and a set of marking stickers is included.

Please see our suggested boat size table on page 77, to assist you in making the correct choice when determining the correct size of fitting for our application.

No.	Description:	Part number	Length (mm)	Width (mm)	Height (mm)	Weight (g)
Rope clutch						
1	Single rope clutch	80500	107	28	62	250
2	Double rope clutch	80501	107	54	62	480
3	Triple rope clutch	80502	107	80	62	710

Mast base organiser

The Barton mast base organiser is finished in our unique ‘Spectro’ grey anodising for a long-lasting finish. It accepts up to four double tang blocks mounted on individual stainless steel swivel posts, but with just three deck fixing points.

The unit is fitted close to the mast base to accept halyards, reefing lines and topping lift and is designed to work in conjunction with our range of deck organisers, rope clutches and winches, doing away with the need to leave the cockpit when reefing, hoisting or lowering the mainsail (see page 7 for setup options).

Specification comprises:

- ‘Spectro’ anodised aluminium base
- Four stainless steel swivel posts with nylon base washers
- Four pairs of nylon packing washers for tang blocks
- Used in conjunction with series 1-4 01090 to 04090 double tang blocks.

(blocks not included).



480500



481550

Compatible blocks:

01090, 01091, 11090 and 11091 from page 10

02090, 02091, 12090 and 12091 from page 12

03090, 03091, 13090 and 13091 from page 14

04090, 04091, 14090 and 14091 from page 16

No.	Description:	Part number	Length (mm)	Width (mm)	Height (mm)	Weight (g)	SWL (kg)	Break load (kg)	Fixing hole (mm)	Swivel post
Mast base organiser										
4	Mast base organiser	81550	160	25	28	166	1540	3080	6	10

Barton DO 550 clutches

For cruising and racing yachts, offering a holding power of up to 550kgs (see chart below).

Modern, high-performance materials

Manufactured from modern lightweight materials, the DO 550 moulded parts are from high-grade plastics which are strong, light and impact-resistant. Cams and bases are from marine grade aluminium, 'Spectro' anodised for long life in the harsh marine environment.

True clutch mechanism

This true clutch mechanism allows line to be adjusted through the unit in the closed, locked position with minimal slippage. Release under load is positive and requires little effort.

The mechanism's opening and closing action is precise and easy to operate, even with cold wet hands. A positive handle lock in the closed position is also featured.

Kind to lines

The clutch's cam and base, manufactured from high-grade extruded aluminium, feature a specially tempered tooth design which allows for maximum grip with minimal slippage, whilst being kind to your lines.

Stainless steel rope fairleads are fitted to both line entry and exit points; a feature which helps to prevent wear to both clutch and lines.

Bolt-together construction for straightforward servicing

The DO 550 clutch range features the advantage of a bolt-together construction which allows for ease of servicing and replacement of parts. A full range of components is available from your Barton stockist.

Ergonomically designed handle

The handle is strong and easy to grip, with a positive smooth lock and unlock action.





A unique feature of this new design is the removable insert on the top face of the handle. These inserts are available packaged separately with a selection for both cruising and racing yachts.

81540 'Cruiser' insert pack contains: main, genoa 1, spin halyard 1, topping lift, spin pole up, spin pole down, blank.

81541 'Racer' insert pack contains: reef 1, cunningham, reef 2, kicker, mainsheet, genoa furling, genoa 2, spin halyard 2, backstay, outhaul, downhaul, blank.

Please see our suggested boat size table on page 77, to assist you in making the correct choice when determining the correct size of fitting for our application.

Specifications

	Max holding power	550kg
	Rope capacity	up to 12mm
	Fastening diameter	6mm
	Fastening centres	79mm

No.	Description:	Part number	Length (mm)	Width (mm)	Height (mm)	Weight (g)
DO 550 clutches						
1	Single DO 550 clutch	81500	133	38	68	343
2	Double DO 550 clutch	81501	133	65	68	544
3	Triple DO 550 clutch	81502	133	91	68	754

Important fitting notes: rope clutches

- When fitting ensure a fair lead straight through the clutch to prevent wear to side plates and/or reduced load capabilities.
- For best performance site clutch approximately 1ft (300mm) forward of the winch to ensure a fair lead both vertically and horizontally.
- Use Barton deck organisers forward of the clutch to gain perfect alignment.
- Always use a bolt-through fastening with a suitable sealant.
- A drilling template is provided on our packaging for your convenience.



No.	Part number
Printed handle inserts	
4 'Cruiser' handle insert pack (7 inserts)	81540
5 'Racer' handle insert pack (12 inserts)	81541
Spare parts	
Handle	81545
Cam	81546
Base	81547
Set of 4 x panhead machine screws and nuts	81548

DO 550 clutches - holding power

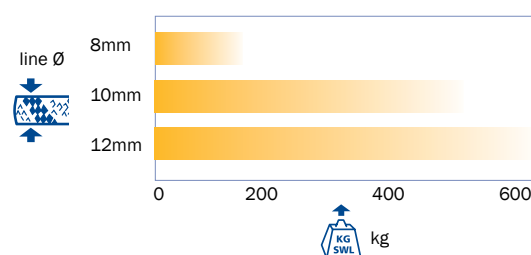

Winch handles and accessories

A range of light duty winch handles and accessories, manufactured from quality modern materials.

All designed to fit international star sockets and standard deck filler caps.

Extruded aluminium handles

Light duty, inexpensive handles in two lengths and either plain or locking. Both styles have easy-grip roller handle and 'Spectro' grey anodised finish.

Important note:

These handles should not be used on large, two-speed winches as they are not designed for high loads in an anti-clockwise direction. SWL 40kg.



Floating handles

Featuring a moulded body with an integral moulded handle shaft. Locking mechanism is with a positive, easy action thumb switch. Handle floats in salt and freshwater.

Important note:

Floating winch handles have a SWL of 40kg and are intended for lightweight use only.



Chrome handle

For use with the now-discontinued '602' bottom handle winch.



Reefing gear handle

For use with the now-discontinued '323' roller reefing gear.

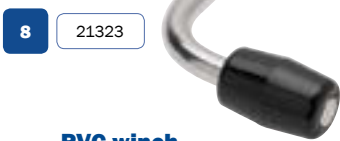

Fabric winch handle pocket

Manufactured from hard wearing synthetic fabric.



PVC winch handle pocket

Manufactured from flexible dip moulded PVC to enable a wide range of handle types to be stored quickly and securely. Includes drainage hole at base.



No.	Description:	Part number	Length (mm)	Weight (g)
Aluminium winch handles				
1	8" Aluminium handle	21001	225	290
2	8" Aluminium handle - locking	21011	225	302
3	10" Aluminium handle	21002	280	335
4	10" Aluminium handle - locking	21022	280	347
Floating winch handles				
5	10" Floating handle - locking	21033	290	306
6	8" Floating handle - locking	21034	235	267
Special handles				
7	Handle for 602 winch	21000	250	420
8	Reefing gear handle	21323	-	160
Winch handle pocket				
9	Fabric winch handle pocket	21050	300	70
10	Moulded PVC winch handle pocket	21053	320	237

Barton composite winches



Barton composite winches

A versatile alternative to conventional aluminium winches, the Barton range of composite winches offer significant cost and weight savings and are truly low maintenance.

Virtually self-lubricating, friction-free and corrosion resistant, the ingenious use of advanced materials ensure consistent performance and reliability.

- Three models available - a single-speed 8:1 and two twin-speeds; 16:1 and 23:1
- Suitable as primaries for yachts up to 10m (30ft) or as spinnaker/halyard winches on larger craft
- Red, blue and green coloured top rings are included, giving you the ability to colour-code winches to control lines, port or starboard, or just to match the colour scheme of your boat
- Comprehensive spares kits available.

(see page 6 for setup options).

See page 77 for our suggested boat size table designed to help you clarify the correct size of winch for your application.

Snubbing winch

Neat, lightweight unit which is ideal for use on larger dinghies and dayboats. Manufactured from glass fibre reinforced nylon with anodised aluminium ribs.



No.	Description:	Part number	Base Ø (mm)	Drum Ø (mm)	Weight (g)
Sheet winches					
1	Single speed 8:1	21200	101.6	66.7	835
2	Twin speed 16:1	21201	114.3	66.7	1264
3	Twin speed 23:1	21202	114.3	66.7	1600
Snubbing winch					
4	Snubbing winch	21101	75	50	230
Spares kit					
	Single speed 8:1	21210	-	-	-
	Twin speed 16:1	21211	-	-	-
	Twin speed 23:1	21212	-	-	-

THE BARTON 'WINCHER'

The Barton 'Wincher'

A specially designed rubber moulding which fits over the top of standard winches, converting them to self-tailing.

This simple operation works when the line is sheeted under load, which means the coils climb up the winch drum and then become gripped by the underside of the Winchers rubber body.

Cleating is achieved by locking the sheet into the Winchers ribbed central groove.

The Barton Winchers are easy to fit and available in four sizes to suit a wide range of popular winches.

Full fitting instructions are included.



1

21643

Fitting instructions

1

Immerse in hot soapy water for 5 mins until supple.

2

Stretch over top of winch with ribs facing downwards.

3

Entire 'Wincher' fits over winch – ribs face downwards & flange sits on winch lip.

4

For self-tailing, entire winch must be stacked with line.

5

To cleat, lock sheet into ribbed groove.

No.	Description:	Part number	Max drum Ø (mm)	Max rope Ø (mm)	Weight (g)
Barton 'Winchers'					
	Wincher small (pair)	21641	64-70	8-10	202
	Wincher medium (pair)	21642	70-80	10-14	223
1	Wincher large (pair)	21643	80-90	12-14	278
	Wincher extra large (pair)	21644	90-100	12-16	387

Wear pads and rubbing strakes

Designed to help sailors and power boaters protect key areas of a boat's deck and superstructure from abrasion, chips, scuffs and wear, our range of wear pads can be applied wherever there is a need to protect a boat's finish without compromising its appearance. Barton produces three wear pad options:

- The PUR (polyurethane) clear
- Kevlar fibre
- Carbon fibre

Offering a choice of performance characteristics, the PUR clear and Kevlar provide the highest protection for extreme use, while the carbon fibre is ideal for everyday levels of use and to protect carbon spars. Wear pads can be customised and cut to size to fit both curved and flat surfaces. The pads are easy to fit and are produced with a UV resistant high bond 3M pressure sensitive backing. Wear pads exhibit excellent resistance to edge lifting, immersion and exposure to salt water.

How to fit wear pads and discs

Ensure that the surface is perfectly clean; remove all traces of dirt, salt, moisture and grease. For rough surfaces, ie. non slip deck surfaces, lightly sand the surface with sandpaper for better adhesion. Align the pad or disc and trim to size with scissors if necessary. Press down firmly with a hard edged plastic tool which is the full width of the pad or disc to provide the necessary pressure at the point of lamination.



1

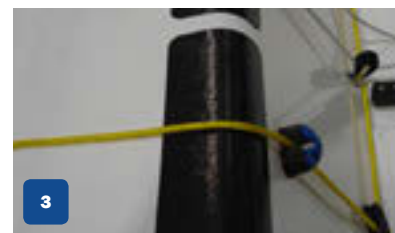

3



6

1 67170



2 67171



3 67150



4 67151



No.		Part number
Wear pads and discs		
1	PUR clear wear pads (rectangular pack of 2)	67170
2	PUR clear pad width 100mm (sold per metre on 6m roll)	67171
3	Carbon fibre rectangular wear pads (rectangular pack of 2)	67150
4	Carbon fibre wear disc	67151
5	Kevlar fibre rectangular wear pads (rectangular pack of 2)	67160
6	Kevlar fibre wear disc	67161

5 67160



6 67161



Stainless steel rubbing strakes

By popular demand Barton Marine introduces a range of stainless steel rubbing strakes, to help prevent rope wear to deck edges and coamings. Available in three lengths these attractive strakes are easy to fit and will last a lifetime. Part numbers and sizing information is as follows:

No.		Part number
Stainless steel rubbing strakes		
7	203 x 19mm	67100
8	305 x 19mm	67101
9	457 x 19mm	67102

7 67100

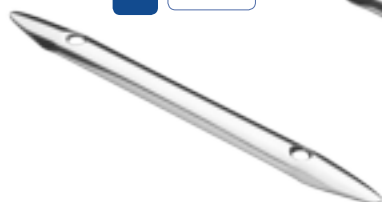

8 67101



9 67102

