

MONITOR MARINE INTERNATIONAL

2115F LATCH WITH SHOOTPIN ENGAGING

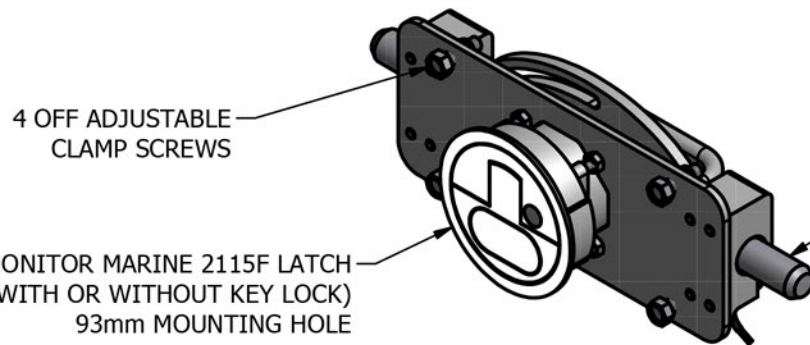

Monitor Marine International
 4 Merse Road, North Moons Moat,
 Redditch, Worcestershire B98 9HL, UK.
 Tel: 0044 (0)1527 61243
 Fax: 0044 (0)1527 66836
 Email: mmi@b-hepworth.com
www.monitor-marine.co.uk

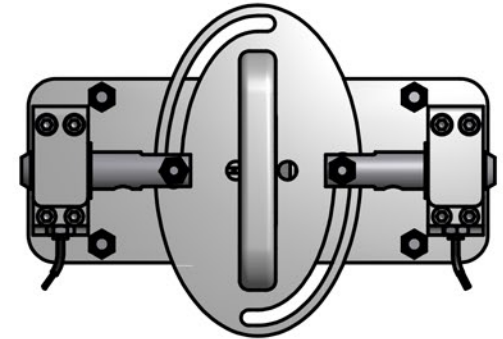
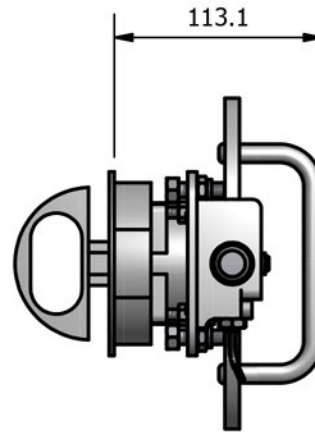
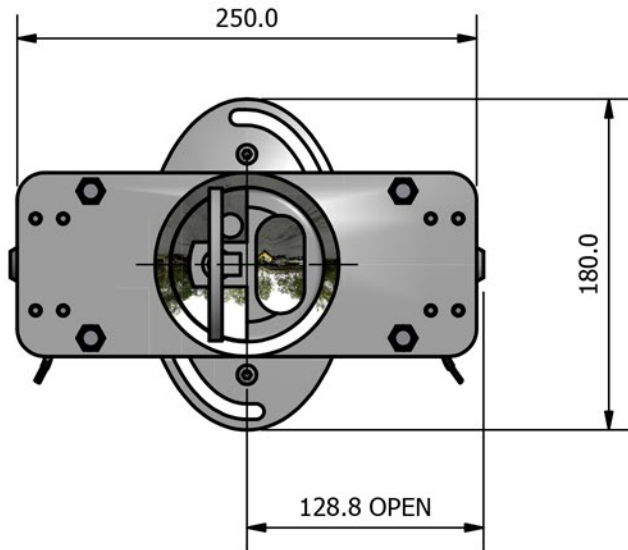

PIN RETRACTED
HATCH OPEN

PIN PROTRUDING
HATCH CLOSED

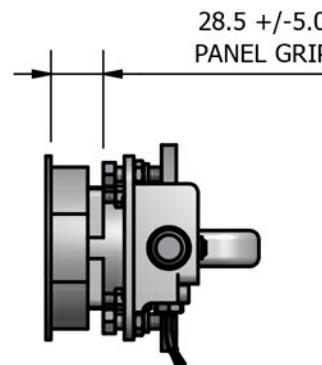
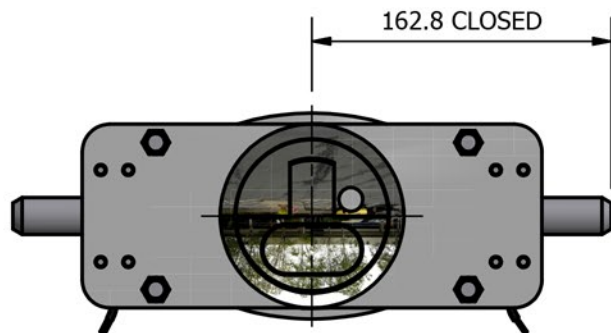
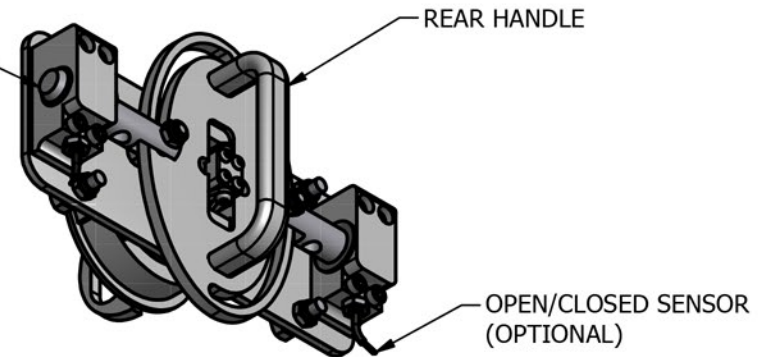

NOTES:

1. DIMENSIONS IN MILLIMETRES
2. MATERIALS: ALL MOVING PARTS STAINLESS STEEL
ALL OTHER PARTS ANODISED ALUMINIUM
3. OPTION OF SINGLE OR DOUBLE SHOOTPIN
4. DIFFERENT LENGTH SHOOTPIN IF REQUIRED
5. PIN RECEPTACLE DESIGN - CUSTOMER SUPPLY